

MODELS AFFECTED: ALL JAZZY, JET, QUANTUM, SCOOTER, AND PMV'S

Date: 1/30/04
To: PRIDE PROVIDERS
From: PRIDE RESEARCH AND DEVELOPMENT
Subject: UPDATED GUIDELINES FOR SEAT MEASUREMENTS

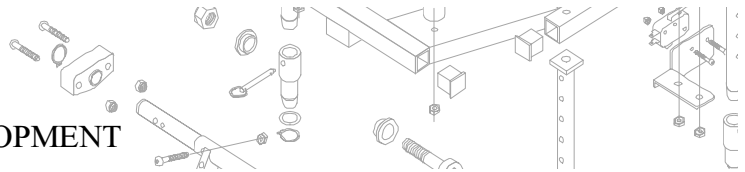

UPDATED GUIDELINES FOR SEAT MEASUREMENTS

Pride has updated its guidelines for measuring usable seat depth and width. This comes in response to customer requests for an easier method that can be performed routinely using common tools. The method is based largely on ANSI/RESNA standards and best practices.

If the seatback angle is adjustable, place it at the 102° setting. Many reclining Pride seats have the 102° position marked in white at the hinge; others offer positions indicated in the owner's manual. Simply select the hole that produces a 102° angle.

Tools Needed: Carpenter's square and tape measure

NOTE: Specifications allow for a tolerance of -1/4 +1/2 inch. For example a designated 18 in. deep seat could measure as little as 17³/₄ in. or as much as 18¹/₂ in.

Measuring Usable Seat Depth— Refer to Figures 1 and 2

1. Position a carpenter's square on the middle of the seat as shown.
2. Slide the square back until it just makes contact with the seatback. Keep the horizontal section of the square parallel with the floor. This will allow for contours such as cushioning "bolsters."
3. Measure the distance between points A and C. This measurement is the seat's usable seat depth.

Measuring Usable Seat Width— Refer to Figure 2

1. Measure 4¹/₂ inches out from point A to find line B-D.
2. Measure the distance between B and D. This measurement is the usable seat width.

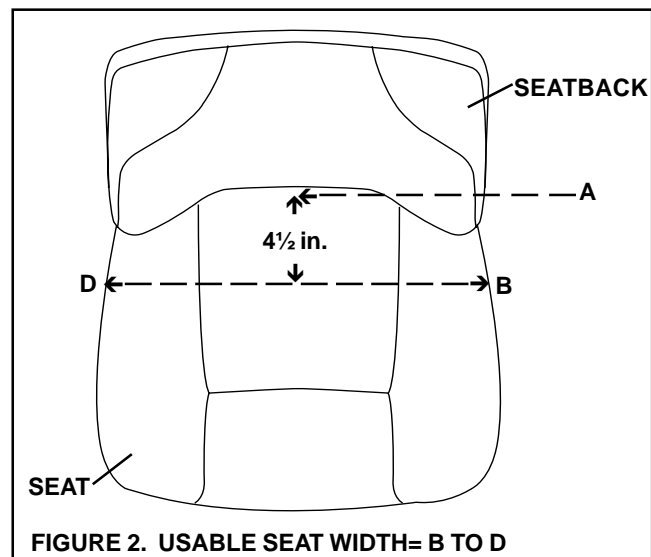
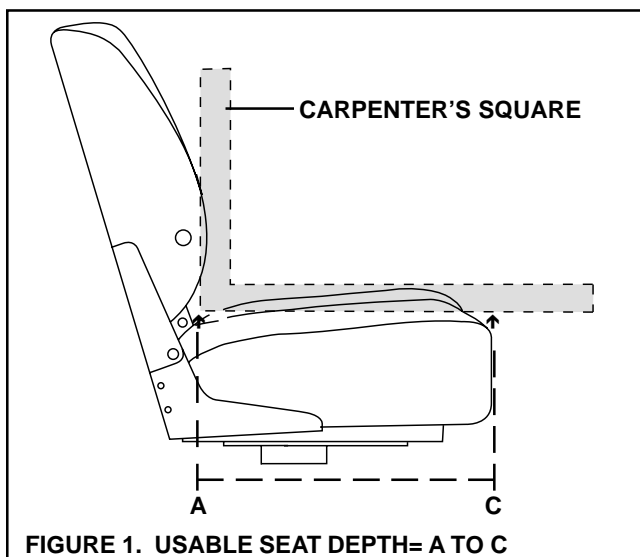

For more information, contact Technical Service at 1-877-800-1248.
Canadian residents please call 1-888-570-1113 for assistance.